

200km in 2 Achievement Ride – 100km Day 2

After km	Total km		
0.0	0.0	Start	<b>Deep Water Point, Mt. Pleasant</b>
2.8	2.8	Head Sth.	On The Esplanade
1.0	3.8	Left	At T junction into Leach Hwy. PSP
3.0	6.8	Left	Into Bullcreek Rd.
1.1	7.9	Right	Into Fifth Av.
0.2	8.1	Continue	To Leach Hwy.
5.2	13.3	Cross	Leach Hwy. into Karel Av.
0.4	13.7	Continue	Towards and cross over Roe Hwy.
2.2	15.9	Continue	Into Berrigan Dr.
4.9	20.8	Left	At roundabout into Jandakot Rd.
1.4	22.2	Right	At T junction into Warton Rd.
6.1	28.3	Left	At T junction into Armadale Rd.
7.0	35.3	Right	Into Tonkin Hwy. PSP
0.3	35.6	Left	At T junction into Thomas Rd.
3.3	38.9	Right	Into Hopkinson Rd.
6.6	45.5	Right	Into Orton Rd.
2.3	47.8	Left	Into King Rd.
2.0	49.8	Right	Into Coyle Rd.
0.4	50.2	Right	At T junction into Casuarina Rd.
3.4	53.6	Left	Into Mortimer Rd.
8.8	62.4	Left	Into Kwinana Fwy. PSP
0.7	63.1	Right	Into PSP to Safety Bay at underpass
0.0	63.1	Rest stop	Baldivis Service Station
0.7	63.8	Retrace	PSP to Kwinana Fwy. PSP
34.7	98.5	Left	Into Kwinana Fwy. PSP
1.5	100.0	Left	Into The Esplanade at Sth. end of Mt. Henry Bridge
		Finish	<b>Deep Water Point</b>

200 Km. IN 2 AR - 100 Km. DAY 2.

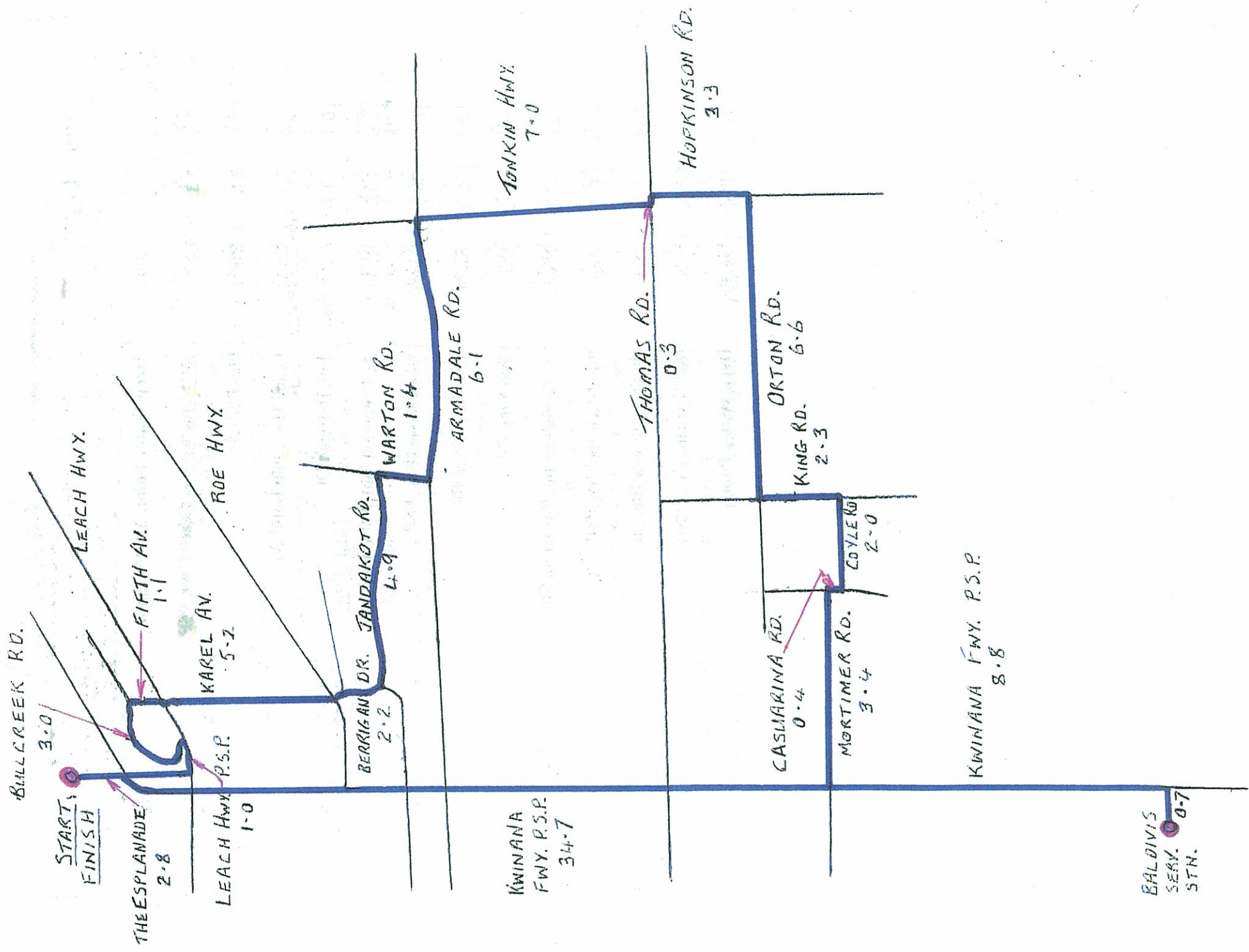

START  
FINISH

THE ESPLANADE  
2.8

LEACH HWY. P.S.R.  
1.0

KARL AV.  
5.2

FIFTH AV.  
1.1

LEACH HWY.

ROE HWY.

BERRIGAN DR.  
2.2

JANDAKOT RD.  
4.9

WARTON RD.  
1.4

ARMADALE RD.  
6.1

TONKIN HWY.  
7.0

KWINANA  
FWY. P.S.R.  
34.7

THOMAS RD.  
0.3

HOPKINSON RD.  
3.3

CASUARINA RD.  
0.4

MORTIMER RD.  
3.4

COYLE RD.  
2.0

ORTON RD.  
6.6

KING RD.  
2.3

KWINANA FWY. P.S.R.  
8.8

BALDIVIS  
SERV. STN.  
0.7